

RoHS Compliant

成品图

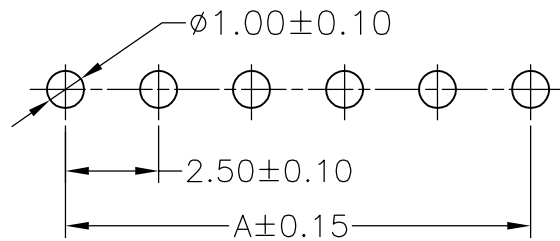

SUGGESTED PCB LAYOUT
(COMPONENT SIDE)

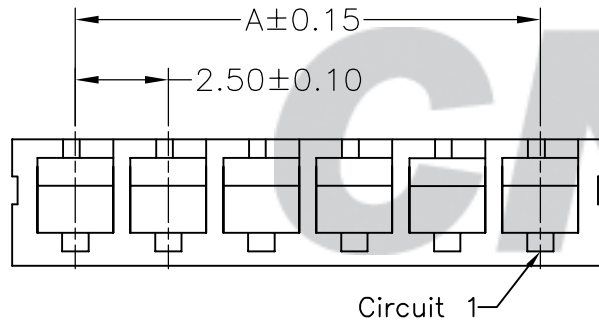
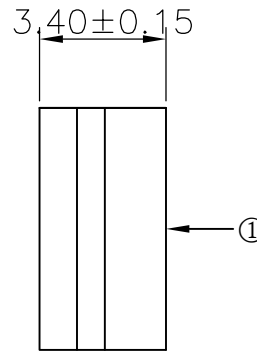
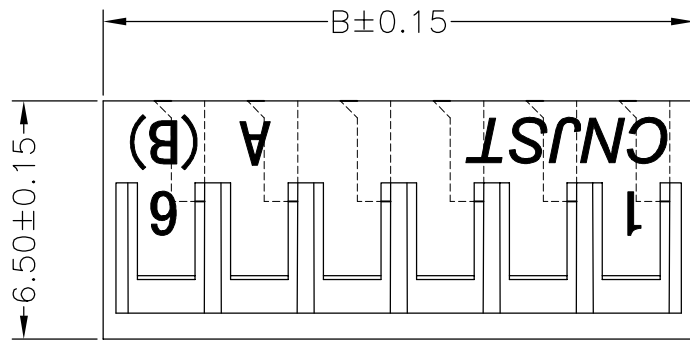
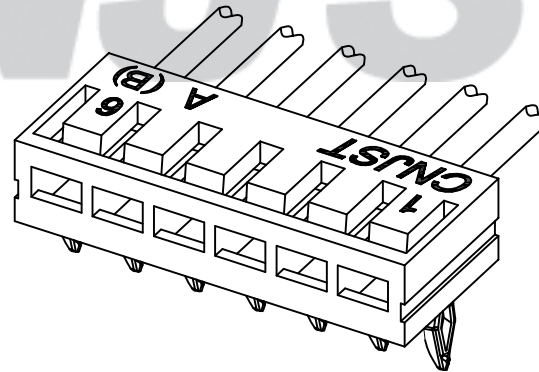

SPECIFICATION

- 1 Insulation resistance: $\geq 1000M\Omega$
- 2 Rated voltage: 250 V AC DC
- 3 Rated current: 3.0 A AC DC
- 4 Withstand Voltage: 800V AC/minute
- 5 Temperature Range: $-25^{\circ}C \sim +85^{\circ}C$

ORDER INFORMATION:

B2502Y--A6W-P**

PART No.	PACKAGING: P=PE
No. OF CIRCUITS: 02~18	PLASTIC MATERIAL: A6W=PA66 (WHITE)

Circuits	Dimensions (mm)		Circuits	Dimensions (mm)	
	A	B		A	B
02	2.50	5.90	10	22.50	25.90
03	5.00	8.40	11	25.00	28.40
04	7.50	10.90	12	27.50	30.90
05	10.00	13.40	13	30.00	33.40
06	12.50	15.90	14	32.50	35.90
07	15.00	18.40	15	35.00	38.40
08	17.50	20.90	16	37.50	40.90
09	20.00	23.40			

Tolerance X.X ±0.30 X.XX ±0.20 X.XXX ±0.10 Angle ±3.0°	Model Name: 2.50mm PITCH 90° HOUSING		Drawn: 蔡忠忠 2016.05.12
	Model No: B2502Y-**-A6W-P		
UNIT: mm	SCALE: FULL	REVISION: B/0	Approved: 刘祚杰
	CNJST 浙江捷仕泰电子有限公司 ZHEJIANG JIESHITAI ELECTRONIC CO., LTD		DWG NO. CNJST/GCCP-0131

REV.	DATE	DESCRIPTION	APPD.	NO.	DESCRIPTION	QTY	MATERIAL	PLATING/COLOR
B/0	2016.05.12	NEW RELEASE		①	Insulator	1	PA66 (UL94V-0)	White